

## First Floor

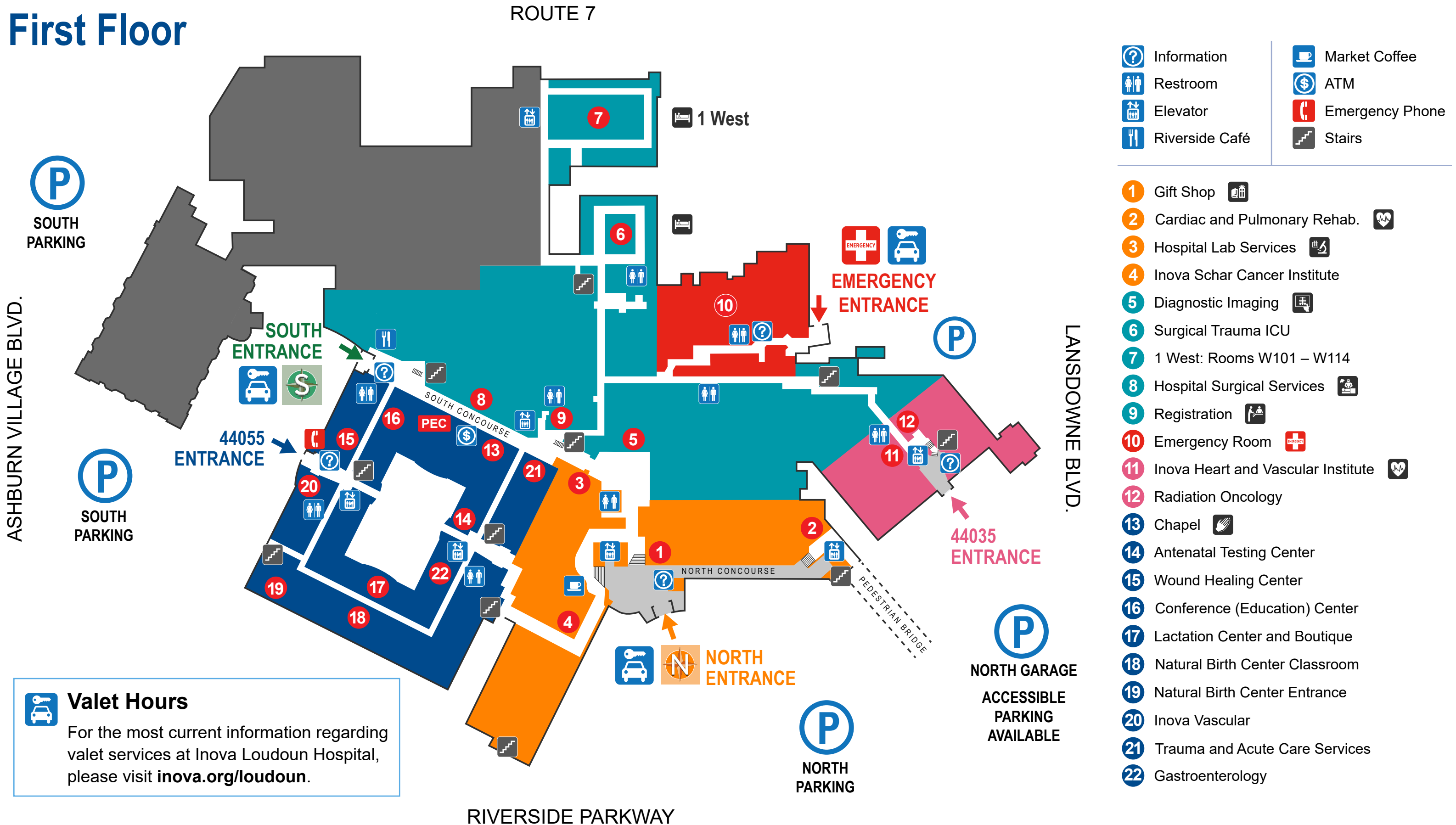

- |                |                 |
|----------------|-----------------|
| Information    | Market Coffee   |
| Restroom       | ATM             |
| Elevator       | Emergency Phone |
| Riverside Café | Stairs          |

- 1 Gift Shop
- 2 Cardiac and Pulmonary Rehab.
- 3 Hospital Lab Services
- 4 Inova Schar Cancer Institute
- 5 Diagnostic Imaging
- 6 Surgical Trauma ICU
- 7 1 West: Rooms W101 – W114
- 8 Hospital Surgical Services
- 9 Registration
- 10 Emergency Room
- 11 Inova Heart and Vascular Institute
- 12 Radiation Oncology
- 13 Chapel
- 14 Antenatal Testing Center
- 15 Wound Healing Center
- 16 Conference (Education) Center
- 17 Lactation Center and Boutique
- 18 Natural Birth Center Classroom
- 19 Natural Birth Center Entrance
- 20 Inova Vascular
- 21 Trauma and Acute Care Services
- 22 Gastroenterology

**Valet Hours**  
 For the most current information regarding valet services at Inova Loudoun Hospital, please visit [inova.org/loudoun](http://inova.org/loudoun).

## Second Floor

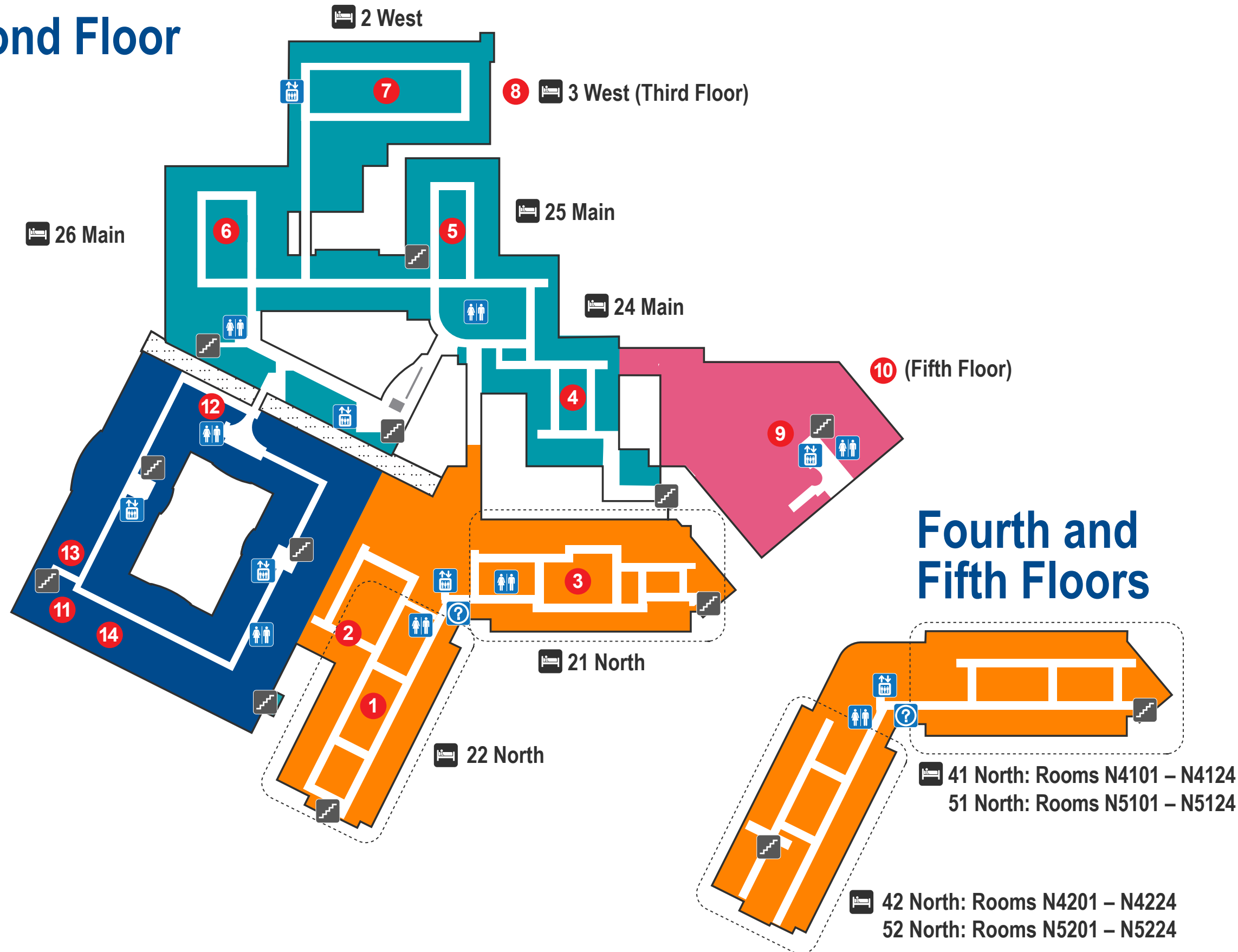

- Information
- Restroom
- Elevator
- Emergency Phone
- Stairs

- 1** 22 North: Labor and Delivery Rooms N2201 – N2216
- 2** 22 North: OB Emergency Dept.
- 3** 21 North: NICU Rooms N2101 – N2116
- 4** 24 Main: Rooms M205 – M230
- 5** 25 Main: Rooms M231 – M245
- 6** 26 Main: Rooms M247 – M274
- 7** Intensive Care Unit (ICU)
- 8** 3 West: Rooms W301 – W314
- 9** Loudoun Ambulatory Surgery Center
- 10** Outpatient Rehabilitation – Fifth Floor
- 11** Inova Cares Clinic for Women
- 12** Hospital Administration
- 13** Inova Thoracic Surgery, Interventional Pulmonology and Inova Virginia Surgery Associates
- 14** Neurosurgery and Urogynecology